





G07

Index

Type	Filament material		
Shank mounted end brushes	Steel, INOX, nylon with SiC		391
Shank mounted wheel brushes	Steel, INOX, brass, nylon with SiC		393
Shank mounted cup brushes	Steel, INOX, nylon with SiC		398
Threaded cup brushes	Steel, INOX		400
Wheel brushes	Steel, INOX		402
Threaded bevel brushes	Steel, INOX		404
Tube brushes	Steel, INOX, brass, nylon with SiC		406
Hand brushes	Steel, INOX, brass		408

Protective equipment required while operation.



Shank mounted end brushes crimped

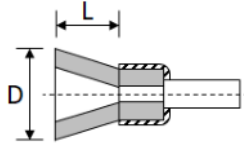

Suitable for light brushing such as deburring, cleaning and derusting. Optimal access to hard-to-reach areas such as drilled holes and cavities as the wires spread out upon rotation.

Recommendations for use:

Power tool min. 300 W. Recommended speed 0,5 x 0,8 max. rpm

Order instruction: HD DP10/6 STEEL 0.30 (HD63280032)

Model	Article No.	D (mm)	L (mm)	Shank (mm)	Wire diameter (mm)	Max. permitted speed rpm	Packaging
Steel							
HD DP10/6 STEEL 0.30	HD63280032	10	20	6	0.30	20,000	10
HD DP17/6 STEEL 0.20	HD63280033	17	20	6	0.20	18,000	10
HD DP17/6 STEEL 0.30	HD63280034	17	20	6	0.30	18,000	10
HD DP22/6 STEEL 0.20	HD63280035	22	25	6	0.20	18,000	10
HD DP22/6 STEEL 0.30	HD63280036	22	25	6	0.30	18,000	10
HD DP25/6 STEEL 0.30	HD63280037	25	25	6	0.30	15,000	10
HD DP30/6 STEEL 0.20	HD63280038	30	25	6	0.20	15,000	10
HD DP30/6 STEEL 0.30	HD63280039	30	25	6	0.30	15,000	10
INOX							
HD DP10/6 INOX 0.30	HD63280040	10	20	6	0.30	20,000	10
HD DP17/6 INOX 0.20	HD63280041	17	20	6	0.20	18,000	10
HD DP17/6 INOX 0.30	HD63280042	17	20	6	0.30	18,000	10
HD DP22/6 INOX 0.20	HD63280043	22	25	6	0.20	18,000	10
HD DP22/6 INOX 0.30	HD63280044	22	25	6	0.30	18,000	10
HD DP30/6 INOX 0.30	HD63280045	30	25	6	0.30	15,000	10

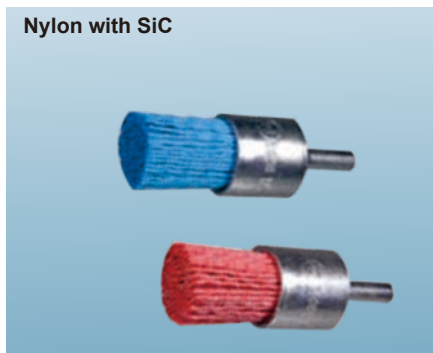

Order instruction: HD DP25/6 SIC 80 (HD63280046)

Model	Article No.	D (mm)	L (mm)	Shank (mm)	Grit size	Max. permitted speed rpm	Packaging
HD DP25/6 SIC 80	HD63280046	25	25	6	80	4,500	12
HD DP25/6 SIC 120	HD63280047	25	25	6	120	4,500	12

Protective equipment required while operation.



Shank mounted end brushes

knotted

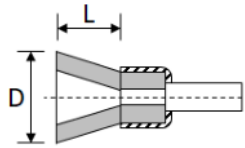
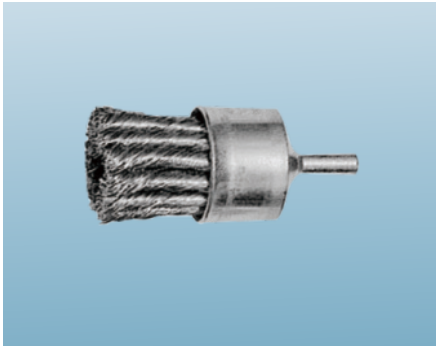

Suitable for medium brushing such as deburring, cleaning and derusting. Optimal access to hard-to-reach areas such as drilled holes and cavities as the wires spread out upon rotation.

Recommendations for use:

Power tool min. 500 W. Recommended speed 0,5 x 0,8 max. rpm

Order instruction: HD DGP22/6 STEEL 0.35 (HD63280049)

Model	Article No.	D (mm)	L (mm)	Shank (mm)	Wire diameter (mm)	Max. permitted speed rpm	Packaging
Steel							
HD DGP19/6 STEEL 0.35	HD63280048	19	28	6	0.35	20,000	10
HD DGP22/6 STEEL 0.35	HD63280049	22	28	6	0.35	18,000	10
HD DGP28/6 STEEL 0.35	HD63280050	28	28	6	0.35	15,000	10
INOX							
HD DGP19/6 INOX 0.35	HD63280051	19	28	6	0.35	20,000	10
HD DGP22/6 INOX 0.35	HD63280052	22	28	6	0.35	18,000	10
HD DGP28/6 INOX 0.35	HD63280053	28	28	6	0.35	15,000	10
HD DGP30/6 INOX 0.35	HD63280054	30	28	6	0.35	12,000	10

G07

Protective equipment required while operation.



Shank mounted wheel brushes crimped

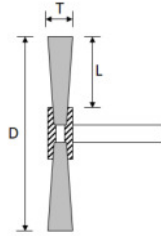

Suitable for multi purpose operations as cleaning, deburring and removal of heat discoloration.

Recommendations for use:

Power tool min. 300 W. Recommended speed 0,5 x 0,8 max. rpm

Order instruction: HD B3009/6 STEEL 0.20 (HD63280056)

Model	Article No.	D (mm)	T (mm)	L (mm)	Shank (mm)	Wire diameter (mm)	Max. permitted speed rpm	Packaging
HD B3006/6 STEEL 0.20	HD63280022	30	6	6	6	0.20	20,000	10
HD B3006/6 STEEL 0.30	HD63280055	30	6	6	6	0.30	20,000	10
HD B3009/6 STEEL 0.20	HD63280056	30	9	6	6	0.20	20,000	10
HD B3009/6 STEEL 0.30	HD63280057	30	9	6	6	0.30	20,000	10
HD B3015/6 STEEL 0.20	HD63280058	30	15	6	6	0.20	20,000	10
HD B3020/6 STEEL 0.30	HD63280059	30	20	6	6	0.30	20,000	10
HD B4006/6 STEEL 0.30	HD63280060	40	6	9	6	0.30	18,000	10
HD B4007/6 STEEL 0.20	HD63280061	40	7-8	9	6	0.20	18,000	10
HD B4010/6 STEEL 0.20	HD63280029	40	10-12	9	6	0.20	18,000	10
HD B4010/6 STEEL 0.30	HD63280030	40	10-12	9	6	0.30	18,000	10
HD B5012/6 STEEL 0.20	HD63280062	50	12	12	6	0.20	15,000	10
HD B5010/6 STEEL 0.30	HD63280063	50	10-12	12	6	0.30	15,000	10
HD B5016/6 STEEL 0.20	HD63280024	50	16-18	12	6	0.20	15,000	10
HD B5016/6 STEEL 0.30	HD63280064	50	16-18	12	6	0.30	15,000	10
HD B5018/6 STEEL 0.30	HD63280065	50	18-20	12	6	0.30	15,000	10
HD B6012/6 STEEL 0.20	HD63280066	60	12	17	6	0.20	15,000	10
HD B6010/6 STEEL 0.30	HD63280067	60	10-12	17	6	0.30	15,000	10
HD B6016/6 STEEL 0.20	HD63280068	60	16-18	17	6	0.20	15,000	10
HD B6016/6 STEEL 0.30	HD63280069	60	16-18	17	6	0.30	15,000	10
HD B6018/6 STEEL 0.30	HD63280070	60	18-20	17	6	0.30	15,000	10
HD B7012/6 STEEL 0.20	HD63280071	70	12	19	6	0.20	15,000	10
HD B7010/6 STEEL 0.30	HD63280072	70	10-12	19	6	0.30	15,000	10
HD B7016/6 STEEL 0.20	HD63280073	70	16-20	19	6	0.20	15,000	10
HD B7016/6 STEEL 0.30	HD63280074	70	16-20	19	6	0.30	15,000	10
HD B8012/6 STEEL 0.20	HD63280075	80	12	20	6	0.20	12,000	10
HD B8016/6 STEEL 0.30	HD63280076	80	16-19	20	6	0.30	12,000	10
HD B8018/6 STEEL 0.20	HD63280077	80	18-20	20	6	0.20	12,000	10

G07

Protective equipment required while operation.



Shank mounted wheel brushes crimped

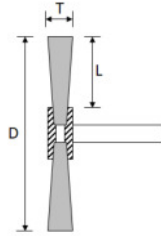

Suitable for multi purpose operations as cleaning, deburring and removal of heat discoloration.

Recommendations for use:

Power tool min. 300 W. Recommended speed 0,5 x 0,8 max. rpm

Order instruction: HD B3008/6 BRASS 0.30 (HD63280079)

Model	Article No.	D (mm)	T (mm)	L (mm)	Shank (mm)	Wire diameter (mm)	Max. permitted speed rpm	Packaging
HD B2006/6 BRASS 0.20	HD63280078	20	6	3	6	0.20	20,000	10
HD B3008/6 BRASS 0.30	HD63280079	30	8	6	6	0.30	20,000	10
HD B3009/6 BRASS 0.20	HD63280080	30	9	6	6	0.20	20,000	10
HD B3010/6 BRASS 0.20	HD63280081	30	10-12	6	6	0.20	20,000	10
HD B3010/6 BRASS 0.08	HD63280082	30	10-12	6	6	0.08	12,000	10
HD B4010/6 BRASS 0.08	HD63280083	40	10	9	6	0.08	10,000	10
HD B4010/6 BRASS 0.30	HD63280084	40	10	9	6	0.30	18,000	10
HD B4012/6 BRASS 0.20	HD63280085	40	12	9	6	0.20	18,000	10
HD B4015/6 BRASS 0.20	HD63280086	40	15-18	9	6	0.20	18,000	10
HD B5006/6 BRASS 0.10	HD63280087	50	6	12	6	0.10	10,000	10
HD B5010/6 BRASS 0.20	HD63280088	50	10-12	12	6	0.20	15,000	10
HD B5016/6 BRASS 0.20	HD63280089	50	16-18	12	6	0.20	15,000	10
HD B6008/6 BRASS 0.20	HD63280090	60	8-9	17	6	0.20	15,000	10
HD B6016/6 BRASS 0.20	HD63280091	60	16-19	17	6	0.20	15,000	10
HD B7010/6 BRASS 0.20	HD63280092	70	10-12	19	6	0.20	12,000	10
HD B7010/6 BRASS 0.30	HD63280093	70	10-12	19	6	0.30	12,000	10
HD B7018/6 BRASS 0.20	HD63280094	70	18-20	19	6	0.20	12,000	10
HD B7018/6 BRASS 0.30	HD63280095	70	18-20	19	6	0.30	12,000	10
HD B8018/6 BRASS 0.20	HD63280096	80	18-20	20	6	0.20	10,000	10

G07

Protective equipment required while operation.



Shank mounted wheel brushes crimped

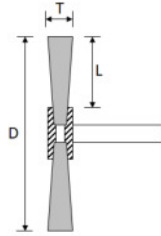

Suitable for multi purpose operations as cleaning, deburring and removal of heat discoloration.

Recommendations for use:

Power tool min. 300 W. Recommended speed 0,5 x 0,8 max. rpm

Order instruction: HD B3005/6 INOX 0.30 (HD63280098)

Model	Article No.	D (mm)	T (mm)	L (mm)	Shank (mm)	Wire diameter (mm)	Max. permitted speed rpm	Packaging
HD B2006/6 INOX 0.20	HD63280097	20	6	3	6	0.20	20,000	10
HD B3005/6 INOX 0.30	HD63280098	30	5	6	6	0.30	20,000	10
HD B3009/6 INOX 0.20	HD63280099	30	9	6	6	0.20	20,000	10
HD B3010/6 INOX 0.30	HD63280100	30	10	6	6	0.30	20,000	10
HD B3012/6 INOX 0.20	HD63280101	30	12	6	6	0.20	20,000	10
HD B4005/6 INOX 0.30	HD63280102	40	5	9	6	0.30	18,000	10
HD B4010/6 INOX 0.20	HD63280103	40	10	9	6	0.20	18,000	10
HD B4010/6 INOX 0.30	HD63280104	40	10	9	6	0.30	18,000	10
HD B4015/6 INOX 0.30	HD63280105	40	15	9	6	0.30	18,000	10
HD B5005/6 INOX 0.30	HD63280106	50	5	12	6	0.30	15,000	10
HD B5010/6 INOX 0.30	HD63280107	50	10	12	6	0.30	15,000	10
HD B5010/6 INOX 0.20	HD63280108	50	10-12	12	6	0.20	18,000	10
HD B5015/6 INOX 0.30	HD63280109	50	15	12	6	0.30	15,000	10
HD B5016/6 INOX 0.20	HD63280110	50	16-18	12	6	0.20	15,000	10
HD B6010/6 INOX 0.20	HD63280111	60	10-12	17	6	0.20	15,000	10
HD B6012/6 INOX 0.30	HD63280112	60	12	17	6	0.30	15,000	10
HD B6016/6 INOX 0.20	HD63280113	60	16-18	17	6	0.20	15,000	10
HD B6016/6 INOX 0.30	HD63280019	60	16-18	17	6	0.30	15,000	10
HD B6025/6 INOX 0.30	HD63280114	60	25	17	6	0.30	15,000	10
HD B7006/6 INOX 0.20	HD63280115	70	6	19	6	0.20	15,000	10
HD B7008/6 INOX 0.30	HD63280116	70	8	19	6	0.30	15,000	10
HD B7010/6 INOX 0.20	HD63280117	70	10-12	19	6	0.20	15,000	10
HD B7012/6 INOX 0.30	HD63280118	70	12	19	6	0.30	15,000	10
HD B7016/6 INOX 0.30	HD63280119	70	16-20	19	6	0.30	15,000	10
HD B7018/6 INOX 0.20	HD63280120	70	18-20	19	6	0.20	15,000	10
HD B8010/6 INOX 0.20	HD63280121	80	10-12	20	6	0.20	12,000	10
HD B8010/6 INOX 0.30	HD63280122	80	10-12	20	6	0.30	12,000	10
HD B8018/6 INOX 0.20	HD63280123	80	18-20	20	6	0.20	12,000	10
HD B8018/6 INOX 0.30	HD63280124	80	18-20	20	6	0.30	12,000	10
HD B10006/6 INOX 0.30	HD63280125	100	6	20	6	0.30	4,500	10
HD B10010/6 INOX 0.20	HD63280126	100	10-12	20	6	0.20	4,500	10
HD B10010/6 INOX 0.30	HD63280127	100	10-12	20	6	0.30	4,500	10
HD B10020/6 INOX 0.30	HD63280128	100	20	20	6	0.30	4,500	10

G07

Protective equipment required while operation.



Shank mounted wheel brushes

Nylon with SiC

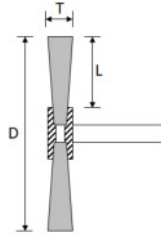

Suitable for multi purpose operations as cleaning, deburring and removal of heat discoloration.

Recommendations for use:

Power tool min. 300 W. Recommended speed 0,5 x 0,8 max. rpm

Order instruction: HD B5010/6 SIC 320 (HD63280130)

Model	Article No.	D (mm)	T (mm)	L (mm)	Shank (mm)	Grit size	Max. permitted speed rpm	Packaging
HD B5010/6 SIC 120	HD63280129	50	10	12	6	120	15,000	10
HD B5010/6 SIC 320	HD63280130	50	10	12	6	320	15,000	10
HD B7012/6 SIC 120	HD63280131	70	12	20	6	120	15,000	10
HD B7012/6 SIC 320	HD63280132	70	12	20	6	320	15,000	10
HD B10008/6 SIC 120	HD63280133	100	8	22	6	120	4,500	10
HD B10008/6 SIC 320	HD63280134	100	8	22	6	320	4,500	10



Shank mounted wheel brushes knotted

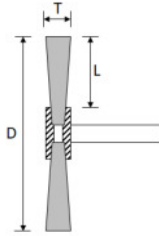

Suitable for multi purpose operations as cleaning, deburring and removal of heat discoloration with aggressive effect.

Recommendations for use:

Power tool min. 500 W. Recommended speed 0,5 x 0,8 max. rpm

Order instruction: HD BG7508/6 STEEL 0.50 (HD63280027)

Model	Article No.	D (mm)	T (mm)	L (mm)	Shank (mm)	Wire diameter (mm)	Max. permitted speed rpm	Packaging
Steel								
HD BG7508/6 STEEL 0.35	HD63280142	75	8	15	6	0.35	25,000	10
HD BG7508/6 STEEL 0.50	HD63280027	75	8	15	6	0.50	25,000	10
HD BG7516/6 STEEL 0.50	HD63280144	75	16	15	6	0.50	25,000	10
INOX								
HD BG7506/6 INOX 0.50	HD63280145	75	6	15	6	0.50	25,000	10

Protective equipment required while operation.

Shank mounted cup brushes crimped

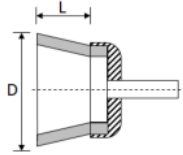

Suitable for cleaning, derusting and smoothing, as well as removal of corrosion and paint on large, flat surfaces.

Recommendations for use:

Power tool min. 300 W. Recommended speed 0,5 x 0,8 max. rpm

Order instruction: HD D50/6 STEEL 0.30 (HD63280028)

Model	Article No.	D (mm)	L (mm)	Shank (mm)	Wire diameter (mm)	Max. permitted speed rpm	Packaging
HD D40/6 STEEL 0.30	HD63280135	40	20	6	0.30	10,500	10
HD D50/6 STEEL 0.30	HD63280028	50	20	6	0.30	4,500	10
HD D60/6 STEEL 0.30	HD63280136	60	25	6	0.30	4,500	10
HD D70/6 STEEL 0.30	HD63280137	70	25	6	0.30	3,500	10



Order instruction: HD D50/6 SIC 180 (HD63280139)

Model	Article No.	D (mm)	L (mm)	Shank (mm)	Grit size	Max. permitted speed rpm	Packaging
HD D50/6 SIC 80	HD63280138	50	17	6	80	4,500	10
HD D50/6 SIC 180	HD63280139	50	17	6	180	4,500	10
HD D75/6 SIC 80	HD63280140	75	23	6	80	4,500	10
HD D75/6 SIC 180	HD63280141	75	23	6	180	4,500	10

G07

Protective equipment required while operation.



Shank mounted cup brushes knotted

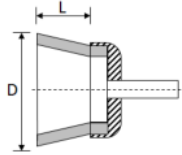

Suitable for cleaning, derusting and smoothing, as well as removal of corrosion and paint on large, flat surfaces with aggressive effect.

Recommendations for use:

Power tool min. 500 W. Recommended speed 0,5 x 0,8 max. rpm

Order instruction: HD DG65/6 STEEL 0.50 (HD63280147)

Model	Article No.	D (mm)	L (mm)	Shank (mm)	Wire diameter (mm)	Max. permitted speed rpm	Packaging
Steel							
HD DG55/6 STEEL 0.50	HD63280146	55	20	6	0.50	10,500	10
HD DG65/6 STEEL 0.50	HD63280147	65	20	6	0.50	4,500	10
INOX							
HD DG55/6 INOX 0.50	HD63280148	55	20	6	0.50	10,500	10
HD DG65/6 INOX 0.50	HD63280149	65	20	6	0.50	4,500	10

Protective equipment required while operation.

Threaded cup brushes crimped

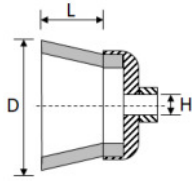

Suitable for medium-duty brushing such as deburring, cleaning and derusting on large surfaces.

Recommendations for use:

Use with powerful speed-adjustable angle grinder. Recommended speed 0,5 - 0,8 x max. rpm.

Order instruction: HD D65/M14 STEEL 0.35 (HD63280150)

Model	Article No.	D (mm)	L (mm)	H (mm)	Wire diameter (mm)	Max. permitted speed rpm	Packaging
Steel							
HD D60/M14 STEEL 0.35	HD63280020	60	20	M 14	0.30-0.35	12,500	1
HD D65/M14 STEEL 0.35	HD63280150	65	20	M 14	0.30-0.35	12,500	1
HD D80/M14 STEEL 0.35	HD63280151	80	25	M 14	0.30-0.35	12,500	1
HD D100/M14 STEEL 0.35	HD63280152	100	30	M 14	0.30-0.35	8,500	1
HD D100/22.2 STEEL 0.35	HD63280153	100	30	22.2	0.30-0.35	8,500	1
HD D125/M14 STEEL 0.35	HD63280154	125	30	M 14	0.30-0.35	6,500	1
HD D125/22.2 STEEL 0.35	HD63280155	125	30	22.2	0.30-0.35	6,500	1
HD D150/M14 STEEL 0.50	HD63280156	150	40	M 14	0.50	6,500	1
INOX							
HD D65/M14 INOX 0.30	HD63280157	65	20	M 14	0.30	12,500	1
HD D80/M14 INOX 0.20	HD63280158	80	25	M 14	0.20	12,500	1
HD D80/M14 INOX 0.30	HD63280159	80	25	M 14	0.30	12,500	1
HD D100/M14 INOX 0.30	HD63280160	100	30	M 14	0.30	8,500	1
HD D125/M14 INOX 0.30	HD63280161	125	30	M 14	0.30	6,500	1



Threaded cup brushes knotted

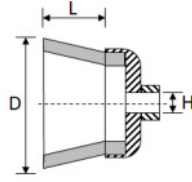

Suitable for heavy-duty brushing such as deburring, cleaning and derusting on large surfaces with aggressive effect.

Recommendations for use:

Use with powerful speed-adjustable angle grinder. Recommended speed 0,5 - 0,8 x max. rpm.

Order instruction: HD DG65/M14 STEEL 0.50 (HD63280162)

Model	Article No.	D (mm)	L (mm)	H (mm)	Wire diameter (mm)	Max. permitted speed rpm	Packaging
Steel							
HD DG65/M14 STEEL 0.35	HD63280021	65	20	M 14	0.35	12,500	1
HD DG65/M14 STEEL 0.50	HD63280162	65	20	M 14	0.50	12,500	1
HD DG80/M14 STEEL 0.35	HD63280163	80	25	M 14	0.35	10,000	1
HD DG80/M14 STEEL 0.50	HD63280164	80	25	M 14	0.50	10,000	1
HD DG80/M14 STEEL 0.80	HD63280165	80	25	M 14	0.80	10,000	1
HD DG80/22.2 STEEL 0.50	HD63280166	80	25	22.2	0.50	10,000	1
HD DG80/22.2 STEEL 0.80	HD63280167	80	25	22.2	0.80	10,000	1
HD DG100/M14 STEEL 0.35	HD63280168	100	23	M 14	0.35	9,000	1
HD DG100/M14 STEEL 0.50	HD63280169	100	23	M 14	0.50	9,000	1
HD DG100/M14 STEEL 0.80	HD63280170	100	23	M 14	0.80	9,000	1
HD DG100/22.2 STEEL 0.50	HD63280171	100	23	22.2	0.50	9,000	1
HD DG120/M14 STEEL 0.50	HD63280172	120	23	M 14	0.50	6,500	1
HD DG120/M14 STEEL 0.80	HD63280173	120	23	M 14	0.80	6,500	1
HD DG120/22.2 STEEL 0.50	HD63280174	120	23	22.2	0.50	6,500	1
HD DG120/22.2 STEEL 0.80	HD63280175	120	23	22.2	0.80	6,500	1
INOX							
HD DG65/M14 INOX 0.35	HD63280176	65	20	M 14	0.35	12,500	1
HD DG65/M14 INOX 0.50	HD63280177	65	20	M 14	0.50	12,500	1
HD DG80/M14 INOX 0.35	HD63280178	80	25	M 14	0.35	10,000	1
HD DG80/M14 INOX 0.50	HD63280179	80	25	M 14	0.50	10,000	1
HD DG100/M14 INOX 0.35	HD63280180	100	23	M 14	0.35	9,000	1
HD DG100/M14 INOX 0.50	HD63280181	100	23	M 14	0.50	9,000	1
HD DG100/22.2 INOX 0.50	HD63280182	100	23	22.2	0.50	9,000	1
HD DG120/M14 INOX 0.50	HD63280183	120	23	M 14	0.50	6,500	1

Protective equipment required while operation.



Wheel brushes

crimped

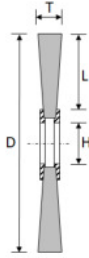

Suitable for medium-duty hand-held or automated brushing of large surfaces.

Recommendations for use:

Apply light pressure and use the wire tips only. Recommended speed 0,5 - 0,8 x max. rpm

Order instruction: HD B10026/16 STEEL 0.30 (HD63280185)

Model	Article No.	D (mm)	T (mm)	L (mm)	H (mm)	Wire diameter (mm)	Max. permitted speed rpm	Packaging
Steel								
HD B8018/30 STEEL 0.30	HD63280184	80	18	20	30	0.30	8,000	1
HD B10026/16 STEEL 0.30	HD63280185	100	26-28	23	16	0.30	8,000	1
HD B12515/16 STEEL 0.30	HD63280186	125	15	27	16	0.30	8,000	1
HD B12522/13 STEEL 0.30	HD63280187	125	22-25	27	13	0.30	8,000	1
HD B12530/13 STEEL 0.30	HD63280188	125	30	27	13	0.30	8,000	1
HD B15022/R40 STEEL 0.35	HD63280318	150	22	33	with converting flanges of the following 7 sizes; 40 / 32 / 1" / 22,23 / 20 / 16 / 1/2"	0.35	6,000	1
HD B15025/32 STEEL 0.30	HD63280189	150	25	33	32	0.30	6,000	1
HD B15030/13 STEEL 0.30	HD63280190	150	30	33	13	0.30	6,000	1
HD B17838/22 STEEL 0.20	HD63280191	178	38	37	22	0.20	6,000	1
HD B18030/16 STEEL 0.30	HD63280192	180	30	37	16	0.30	6,000	1
HD B20030/32 STEEL 0.30	HD63280193	200	30	48	32	0.30	4,500	1
HD B20035/16 STEEL 0.30	HD63280194	200	35	48	16	0.30	4,500	1
HD B25020/20 STEEL 0.30	HD63280195	250	20	48	20	0.30	4,500	1
HD B25060/50 STEEL 0.30	HD63280196	250	60	50	50	0.30	3,600	1
HD B30033/32 STEEL 0.30	HD63280197	300	33	60	32	0.30	3,000	1
INOX								
HD B8025/12 INOX 0.30	HD63280198	80	25	20	12	0.30	8,000	1
HD B10020/19 INOX 0.30	HD63280199	100	20	23	19	0.30	8,000	1
HD B12522/20 INOX 0.30	HD63280200	125	22	27	20	0.30	8,000	1
HD B15023/R50 INOX 0.30	HD63280319	150	23	33	with converting flanges of the following 7 sizes; 50 / 32 / 1" / 22,23 / 20 / 16 / 1/2"	0.30	6,000	1
HD B15020/12 INOX 0.30	HD63280201	150	20	33	12	0.30	6,000	1
HD B17832/50 INOX 0.30	HD63280202	178	32	37	50	0.30	6,000	1
HD B20060/20 INOX 0.30	HD63280203	200	60	48	20	0.30	4,500	1
HD B25022/32 INOX 0.30	HD63280204	250	22-25	50	32	0.30	4,500	1

G07

Protective equipment required while operation.



Wheel brushes knotted

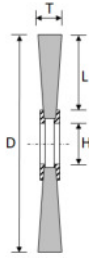

Suitable for heavy-duty hand-held or automated brushing of large surfaces with aggressive effect.

Recommendations for use:

Use on powerful angle grinder. Recommended speed 0,5 - 0,8 x max. rpm

Order instruction: HD BG10011/22.2 STEEL 0.50 (HD63280206)

Model	Article No.	D (mm)	T (mm)	L (mm)	H (mm)	Wire diameter (mm)	Max. permitted speed rpm	Packaging
Steel								
HD BG10011/22.2 STEEL 0.35	HD63280205	100	11	22	22.2	0.35	20,000	1
HD BG10011/22.2 STEEL 0.50	HD63280206	100	11	22	22.2	0.50	20,000	1
HD BG10011/M14 STEEL 0.50	HD63280207	100	11	22	M 14	0.50	20,000	1
HD BG11511/22.2 STEEL 0.50	HD63280208	115	11	24	22.2	0.50	12,500	1
HD BG11511/M14 STEEL 0.50	HD63280209	115	11	24	M 14	0.50	12,500	1
HD BG12512/22.2 STEEL 0.50	HD63280210	125	12	29	22.2	0.50	11,000	1
HD BG12512/M14 STEEL 0.50	HD63280211	125	12	29	M 14	0.50	11,000	1
HD BG15012/22.2 STEEL 0.50	HD63280212	150	12	32	22.2	0.50	10,000	1
HD BG15012/M14 STEEL 0.50	HD63280213	150	12	32	M 14	0.50	10,000	1
HD BG17812/22.2 STEEL 0.50	HD63280214	178	12	38	22.2	0.50	9,000	1
HD BG17812/22.2 STEEL 0.80	HD63280215	178	12	38	22.2	0.80	9,000	1
HD BG17812/M14 STEEL 0.50	HD63280216	178	12	38	M 14	0.50	9,000	1

INOX

HD BG10011/22.2 INOX 0.35	HD63280217	100	11	22	22.2	0.35	20,000	1
HD BG10011/M14 INOX 0.50	HD63280218	100	11	22	M 14	0.50	20,000	1
HD BG11511/22.2 INOX 0.50	HD63280219	115	11	24	22.2	0.50	12,500	1
HD BG11511/22.2 INOX 0.80	HD63280220	115	11	24	22.2	0.80	12,500	1
HD BG11511/M14 INOX 0.50	HD63280221	115	11	29	M 14	0.50	12,500	1
HD BG12512/22.2 INOX 0.50	HD63280222	125	12	29	22.2	0.50	11,000	1
HD BG12512/M14 INOX 0.50	HD63280223	125	12	29	M 14	0.50	11,000	1
HD BG15012/22.2 INOX 0.50	HD63280224	150	12	32	22.2	0.50	10,000	1
HD BG15012/M14 INOX 0.50	HD63280225	150	12	32	M 14	0.50	10,000	1
HD BG17812/22.2 INOX 0.50	HD63280226	178	12	38	22.2	0.50	9,000	1
HD BG17812/M14 INOX 0.50	HD63280227	178	12	38	M 14	0.50	9,000	1

Steel wire, encapsulated



Special type for brushing of laser weld seams, e.g. at car bodies

Recommendations for use:

Apply light pressure and use the wire tips only. Recommended speed 0,5 - 0,8 x max. rpm

Model	Article No.	D (mm)	T (mm)	H (mm)	Wire diameter (mm)	Max. permitted speed	Packaging
HD BE20003/25 STEEL 0.2	HD63280025	200	3	25	0.20	6,000	4

Protective equipment required while operation.



G07

Threaded bevel brushes crimped

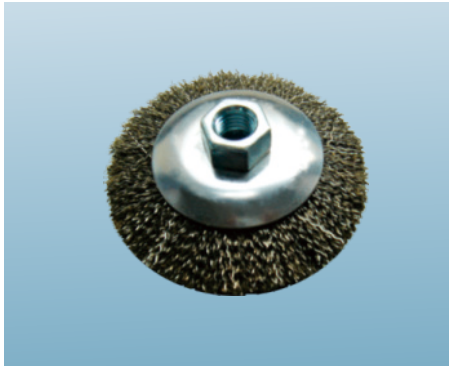

Description: Steel wire brush, crimped steel wire

Applicable materials: steel, cast iron

Application: cleaning of paint, rust, burr and black oxide

Advantages: steady, strong grinding force

Application suggestion: revolving speed of instrument < Maximum revolving speed of Steel wire brush; safety goggles and other protective equipments are needed while operation.

Applicable Industries: metal processing, shipbuilding and ship repairing, steelwork, pipeline.

Order instruction: Model No. (Article No.), such as HD BK10010/N14 STEEL 0.30 (HD63280228)

Suggestion of operating speed: the revolving speed of steel wire wheel < 50%-80% of maximum revolving speed, which can get the best working condition and stable quality.

Model	Article No.	D (mm)	T (mm)	L (mm)	H (mm)	Wire diameter (mm)	Max. permitted speed rpm	 Packaging
Steel								
HD BK10010/M14 STEEL 0.30	HD63280228	100	10	20	M 14	0.30	12,500	1
HD BK10010/M14 STEEL 0.50	HD63280229	100	10	20	M 14	0.50	12,500	1
INOX								
HD BK10010/M14 INOX 0.30	HD63280230	100	10	20	M 14	0.30	12,500	1
HD BK11510/M14 INOX 0.30	HD63280231	115	10	24	M 14	0.30	12,500	1



Threaded bevel brushes knotted



Model	Article No.	D (mm)	T (mm)	L (mm)	H (mm)	Wire diameter (mm)	Max. permitted speed rpm	Packaging
Steel								
HD BGK10012/M14 STEEL 0.50	HD63280232	100	12	20	M 14	0.50	20,000	1
HD BGK11512/M14 STEEL 0.35	HD63280233	115	12	24	M 14	0.35	15,000	1
HD BGK11512/M14 STEEL 0.50	HD63280234	115	12	24	M 14	0.50	15,000	1
HD BGK12512/M14 STEEL 0.50	HD63280235	125	12	19	M 14	0.50	15,000	1
INOX								
HD BGK10012/M14 INOX 0.50	HD63280236	100	12	20	M 14	0.50	20,000	1
HD BGK11512/M14 INOX 0.35	HD63280237	115	12	24	M 14	0.35	15,000	1
HD BGK11512/M14 INOX 0.50	HD63280238	115	12	24	M 14	0.50	15,000	1
HD BGK12512/M14 INOX 0.50	HD63280239	125	12	19	M 14	0.50	15,000	1

G07

Protective equipment required while operation.

Tube brushes

Metal wire, with threaded end

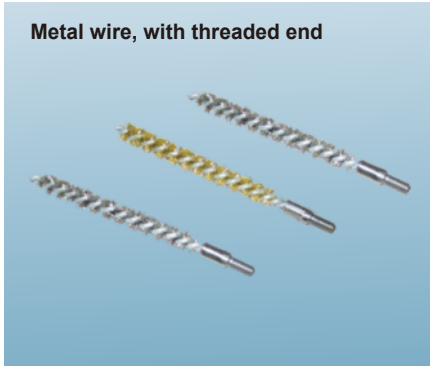

Suitable for deburring and cleaning pipes, threads, coupling sleeves and cylinder

Recommendations for use: rpm < 1.000 min⁻¹

Order instruction: HTB 0675/M6 STEEL 0.15 (HD63280240)

Model	Article No.	Diameter (mm)	Working length (mm)	Overall length (mm)	Wire diameter (mm)	Thread	 packaging
Steel							
HTB 0675/M6 STEEL 0.15	HD63280240	6	75	115	0.15	M6	10
HTB 0875/M6 STEEL 0.15	HD63280241	8	75	115	0.15	M6	10
HTB 1075/M6 STEEL 0.15	HD63280242	10	75	115	0.15	M6	10
HTB 1275/M6 STEEL 0.20	HD63280243	12	75	115	0.20	M6	10
HTB 1475/M6 STEEL 0.20	HD63280244	14	75	115	0.20	M6	10
HTB 1675/M6 STEEL 0.20	HD63280245	16	75	115	0.20	M6	10
HTB 1875/M6 STEEL 0.20	HD63280246	18	75	115	0.20	M6	10
HTB 2075/M6 STEEL 0.20	HD63280247	20	75	115	0.20	M6	10
HTB 2575/M6 STEEL 0.20	HD63280248	25	75	115	0.20	M6	10
HTB 3075/M6 STEEL 0.20	HD63280249	30	75	115	0.20	M6	10
Brass							
HTB 0675/M6 BRASS 0.15	HD63280250	6	75	115	0.15	M6	10
HTB 0875/M6 BRASS 0.15	HD63280251	8	75	115	0.15	M6	10
HTB 1075/M6 BRASS 0.15	HD63280252	10	75	115	0.15	M6	10
HTB 1675/M6 BRASS 0.15	HD63280253	16	75	115	0.15	M6	10
HTB 2080/M6 BRASS 0.20	HD63280254	20	80	115	0.20	M6	10
HTB 2280/M6 BRASS 0.20	HD63280255	22	80	115	0.20	M6	10
INOX							
HTB 0675/M6 INOX 0.15	HD63280256	06	75	115	0.15	M6	10
HTB 0880/M6 INOX 0.20	HD63280257	08	80	115	0.2	M6	10
HTB 1080/M6 INOX 0.20	HD63280258	10	80	115	0.2	M6	10
HTB 1280/M6 INOX 0.20	HD63280259	12	80	115	0.2	M6	10
HTB 1380/M6 INOX 0.20	HD63280260	13	80	115	0.2	M6	10
HTB 1480/M6 INOX 0.20	HD63280261	14	80	115	0.2	M6	10
HTB 1580/M6 INOX 0.20	HD63280262	15	80	115	0.2	M6	10
HTB 1680/M6 INOX 0.20	HD63280263	16	80	115	0.2	M6	10
HTB 1880/M6 INOX 0.20	HD63280264	18	80	115	0.2	M6	10
HTB 2080/M6 INOX 0.20	HD63280265	20	80	115	0.2	M6	10
HTB 2280/M6 INOX 0.20	HD63280266	22	80	115	0.2	M6	10



Tube brushes

Nylon with SiC, with threaded end

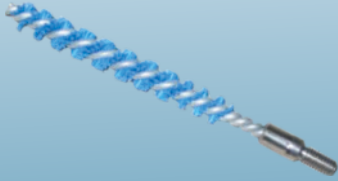

Suitable for deburring and cleaning pipes, threads, coupling sleeves and cylinder

Recommendations for use: rpm < 1.000 min⁻¹

Order instruction: HTB 0680/M6 SIC 180 (HD63280267)

Model	Article No.	Diameter (mm)	Working length (mm)	Overall length (mm)	Grit size	Thread	packaging
HTB 0680/M6 SIC 180	HD63280267	6	80	115	180	M6	10
HTB 0880/M6 SIC 180	HD63280268	8	80	115	180	M6	10
HTB 1080/M6 SIC 180	HD63280269	10	80	115	180	M6	10
HTB 1280/M6 SIC 180	HD63280270	12	80	115	180	M6	10
HTB 1380/M6 SIC 180	HD63280271	13	80	115	180	M6	10
HTB 1580/M6 SIC 180	HD63280272	15	80	115	180	M6	10
HTB 1680/M6 SIC 180	HD63280273	16	80	115	180	M6	10
HTB 1880/M6 SIC 180	HD63280274	18	80	115	180	M6	10
HTB 2080/M6 SIC 180	HD63280275	20	80	115	180	M6	10
HTB 2280/M6 SIC 180	HD63280276	22	80	115	180	M6	10

NEW Honing brushes

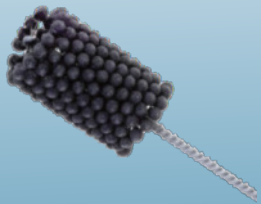

Suitable for honing of cylinders and cleaning and deburring of bores / tubes.

Recommendations for use: rpm < 1.000 min⁻¹, use honing oil when honing cylinders

Order instruction: HTBR 0421 SIC 180 (HD63280365)

Model	Grit size		Diameter (mm)	Working length (mm)	Overall length (mm)	Packaging
	120	180				
	Article No.					
HTBR 0421 SIC ...	-	HD63280365	4	21	150	20
HTBR 0853 SIC ...	HD63280366	HD63280367	8	53	203	20
HTBR 0953 SIC ...	HD63280368	HD63280369	9	53	203	20
HTBR 1053 SIC ...	HD63280370	HD63280371	10	53	203	20
HTBR 1365 SIC ...	HD63280372	HD63280373	12.7	65	203	20
HTBR 1465 SIC ...	HD63280374	HD63280375	14	65	203	20
HTBR 1665 SIC ...	HD63280376	HD63280377	16	65	203	20
HTBR 1865 SIC ...	HD63280378	HD63280379	18	65	203	20
HTBR 2065 SIC ...	HD63280380	HD63280381	20	65	203	20
HTBR 2265 SIC ...	HD63280382	HD63280383	22	65	203	20
HTBR 2580 SIC ...	HD63280384	HD63280385	25.4	80	203	20
HTBR 2980 SIC ...	HD63280386	HD63280387	29	80	203	20
HTBR 3280 SIC ...	HD63280388	HD63280389	31.8	80	203	20
HTBR 3580 SIC ...	HD63280390	HD63280391	35	80	203	20
HTBR 3880 SIC ...	HD63280392	HD63280393	38	80	203	20
HTBR 4180 SIC ...	HD63280394	HD63280395	41	80	203	20
HTBR 4580 SIC ...	HD63280396	HD63280397	45	80	203	20
HTBR 4880 SIC ...	HD63280398	HD63280399	48	80	203	20
HTBR 5180 SIC ...	HD63280400	HD63280401	51	80	203	20

Protective equipment required while operation.



G07

Metal hand brush

straight

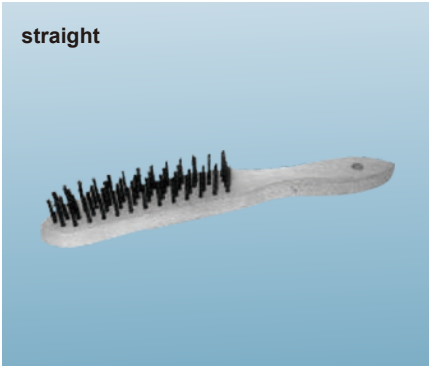

Suitable for cleaning and derusting.

Order instruction: HD BS 1/15 STEEL 0.35 (HD63280279)

Model	Filament material				Overall length (mm)	Rows	Working length (mm)	Working width (mm)	Working height (mm)	Packaging
	STEEL 0.35	INOX 0.35		Article No.						
HD BS 1/15	HD63280279	HD63280285		280	1	135-140	5-35	23	24	
HD BS 2/15	HD63280280	HD63280286		280	2	135-140		23	24	
HD BS 3/15	HD63280281	HD63280287		280	3	135-140		23	24	
HD BS 4/15	HD63280282	HD63280288		280	4	135-140		23	24	
HD BS 5/15	HD63280283	HD63280289		280	5	135-140		23	24	
HD BS 6/15	HD63280284	HD63280290		280	6	135-140		23	24	

crimped

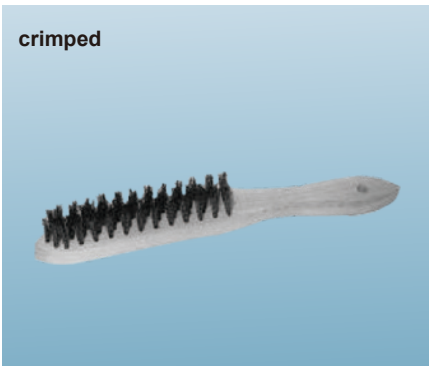

Suitable for cleaning and derusting.

Order instruction: HD BS 1/15 STEEL 0.30 (HD63280291)

Model	Filament material				Overall length (mm)	Rows	Working length (mm)	Working width (mm)	Working height (mm)	Packaging
	STEEL 0.30	BRASS 0.25	BRASS 0.35	INOX 0.35						
	Article No.									
HD BC 1/15	HD63280291	HD63280297	HD63280303	HD63280309	280	1	135-140	5-35	23	24
HD BC 2/15	HD63280292	HD63280298	HD63280304	HD63280310	280	2	135-140		23	24
HD BC 3/15	HD63280293	HD63280299	HD63280305	HD63280311	280	3	135-140		23	24
HD BC 4/15	HD63280294	HD63280300	HD63280306	HD63280312	280	4	135-140		23	24
HD BC 5/15	HD63280295	HD63280301	HD63280307	HD63280313	280	5	135-140		23	24
HD BC 6/15	HD63280296	HD63280302	HD63280308	HD63280314	280	6	135-140		23	24

G07

Protective equipment required while operation.



Metal hand brush



Excellent for cleaning work in hard-to-reach areas, e.g. angles, corners and pipes.

Order instruction: Model No. (Article No.), such as HD BC265 STEEL 0.30 (HD63280023)

Model	Article No.	Filament material	Overall length (mm)	Working length (mm)	Working height (mm)	Wire diameter (mm)	Packaging
HD BC265 STEEL 0.30	HD63280023	Steel	256	140	25	0.30	24
HD BC265 BRASS 0.30	HD63280277	Brass	256	140	25	0.30	24
HD BC265 INOX 0.30	HD63280278	INOX	256	140	25	0.30	24



Suitable for cleaning and derusting fillet welds and V-shaped welds thanks to the V shape

Order instruction: HD BS 1/15 STEEL 0,35 (HD63280279)

Model	Article No.	Filament material	Wire diameter (mm)	Overall length (mm)	Working length (mm)	Rows	Working height (mm)	Packaging
HD BV 3/14 STEEL 0.35	HD63280316	steel	0.35	280	140	3	35	12
HD BV 3/14 INOX 0.35	HD63280315	stainless steel	0.35	280	140	3	35	12



Suitable for cleaning spark plugs, small workpieces and tools

Model	Article No.	Filament material	Wire diameter (mm)	Overall length (mm)	Working length (mm)	Rows	Working height (mm)	Packaging
HD BC145 BRASS 0.15	HD63280317	brass	0.15	145	15	3	15	24

Protective equipment required while operation.



